

Titan DT Technical - Frame

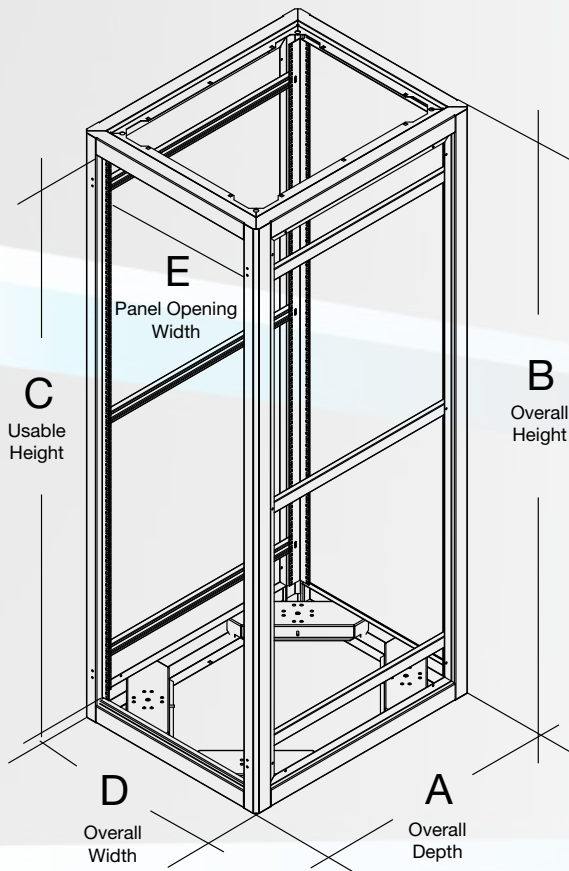

- Certified Static Load Rating - 5,400 lbs.
- Certified Dynamic Load Rating - 3,300 lbs.
- 14 ga. (.074) CRS uni-strut channels (sides) are welded to dual return flanges.
- Formed 12 ga. (.104) CRS gussets are welded to frame base corners for added strength and also serve as caster brackets.
- Easy front-to-rear, full-depth equipment adjustments based on uni-strut design.
- Four weld studs are included in each frame base for grounding requirements.

Add to overall height

- Heavy duty casters - 1.75"
- Light duty casters - 1"

Certifications and Testing

- UL Certified UL 2416
- EIA 310D Equipment Mounting
- Mil Std. 810D Vibration

24" Width (Material: 14ga. CRS)

RU Height	42" Depth (A) (39.75" usable)	45" Depth (A) (42.75" usable)	48" Depth (A) (45.75" usable)	Overall Height (B)	Usable Height (C)	Overall Width (D)	Panel Opening Width (E)
52	R-TN-52U24-42	R-TN-52U24-45	R-TN-52U24-48	98"	89.25"	24"	19.75"
48	R-TN-48U24-42	R-TN-48U24-45	R-TN-48U24-48	91"	82.25"	24"	19.75"
44	R-TN-44U24-42	R-TN-44U24-45	R-TN-44U24-48	84"	77"	24"	19.75"
42	R-TN-42U24-42	R-TN-42U24-45	R-TN-42U24-48	80.5"	73.5"	24"	19.75"

Note: Overall height includes leg levelers (.625")

29" Width (Material: 14ga. CRS)

RU Height	42" Depth (A) (39.75" usable)	45" Depth (A) (42.75" usable)	48" Depth (A) (45.75" usable)	Overall Height (B)	Usable Height (C)	Overall Width (D)	Panel Opening Width (E)
52	R-TN-52U29-42	R-TN-52U29-45	R-TN-52U29-48	98"	89.25"	29"	24.75"
48	R-TN-48U29-42	R-TN-48U29-45	R-TN-48U29-48	91"	82.25"	29"	24.75"
44	R-TN-44U29-42	R-TN-44U29-45	R-TN-44U29-48	84"	77"	29"	24.75"
42	R-TN-42U29-42	R-TN-42U29-45	R-TN-42U29-48	80.5"	73.5"	29"	24.75"

Note: Overall height includes leg levelers (.625")

32" Width (Material: 14ga. CRS)

RU Height	42" Depth (A) (39.75" usable)	45" Depth (A) (42.75" usable)	48" Depth (A) (45.75" usable)	Overall Height (B)	Usable Height (C)	Overall Width (D)	Panel Opening Width (E)
52	R-TN-52U32-42	R-TN-52U32-45	R-TN-52U32-48	98"	89.25"	32"	27.75"
48	R-TN-48U32-42	R-TN-48U32-45	R-TN-48U32-48	91"	82.25"	32"	27.75"
44	R-TN-44U32-42	R-TN-44U32-45	R-TN-44U32-48	84"	77"	32"	27.75"
42	R-TN-42U32-42	R-TN-42U32-45	R-TN-42U32-48	80.5"	73.5"	32"	27.75"

Note: Overall height includes leg levelers (.625")