

PARTS AND HARDWARE

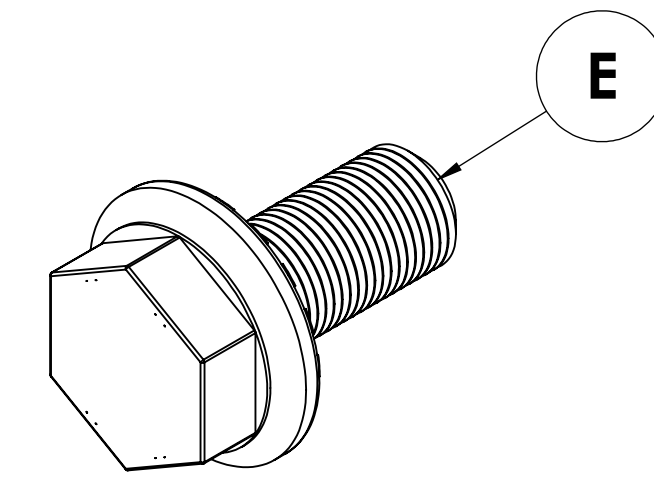

1/4-20 X 1/2L
HEX HEAD SCREW
H448-8BL

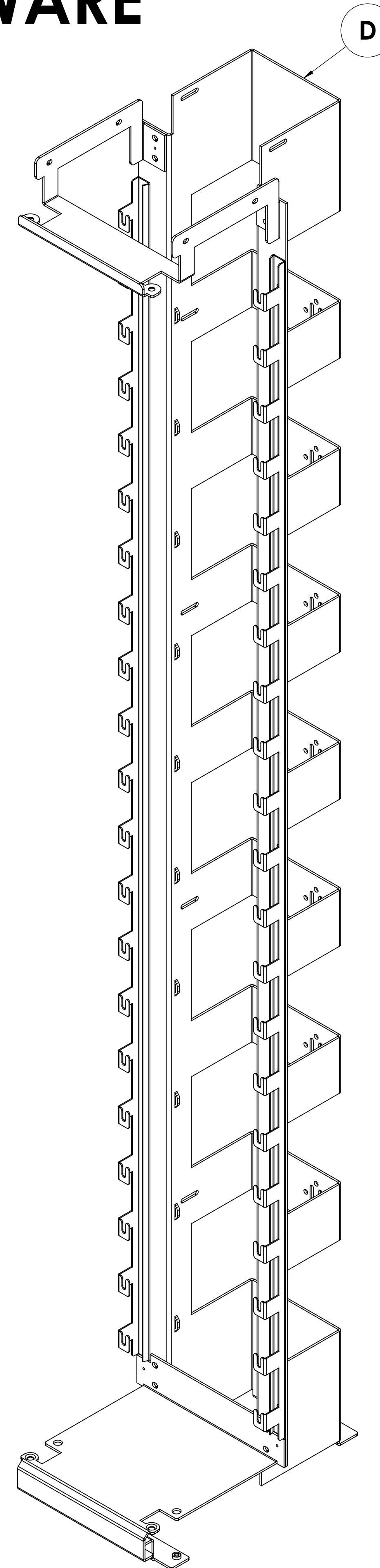
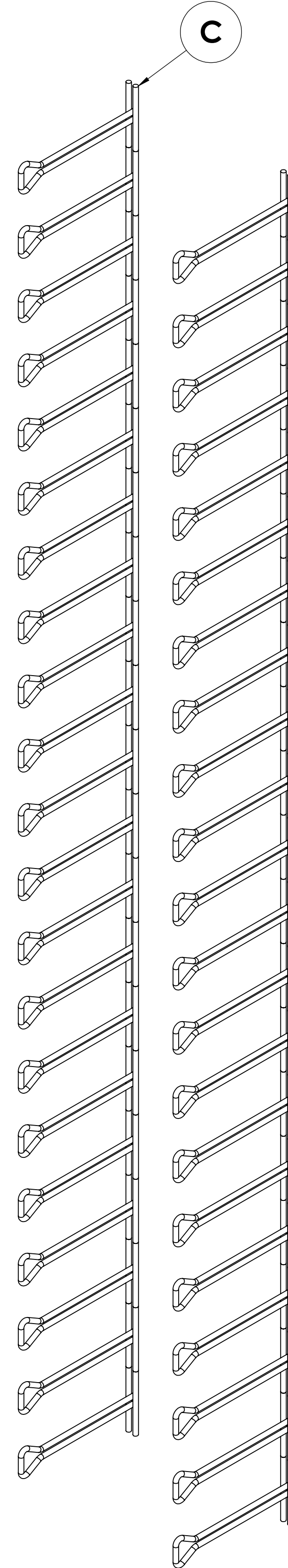
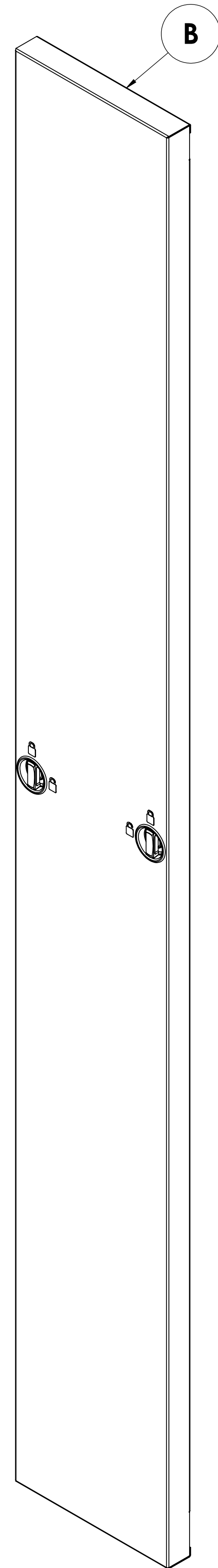
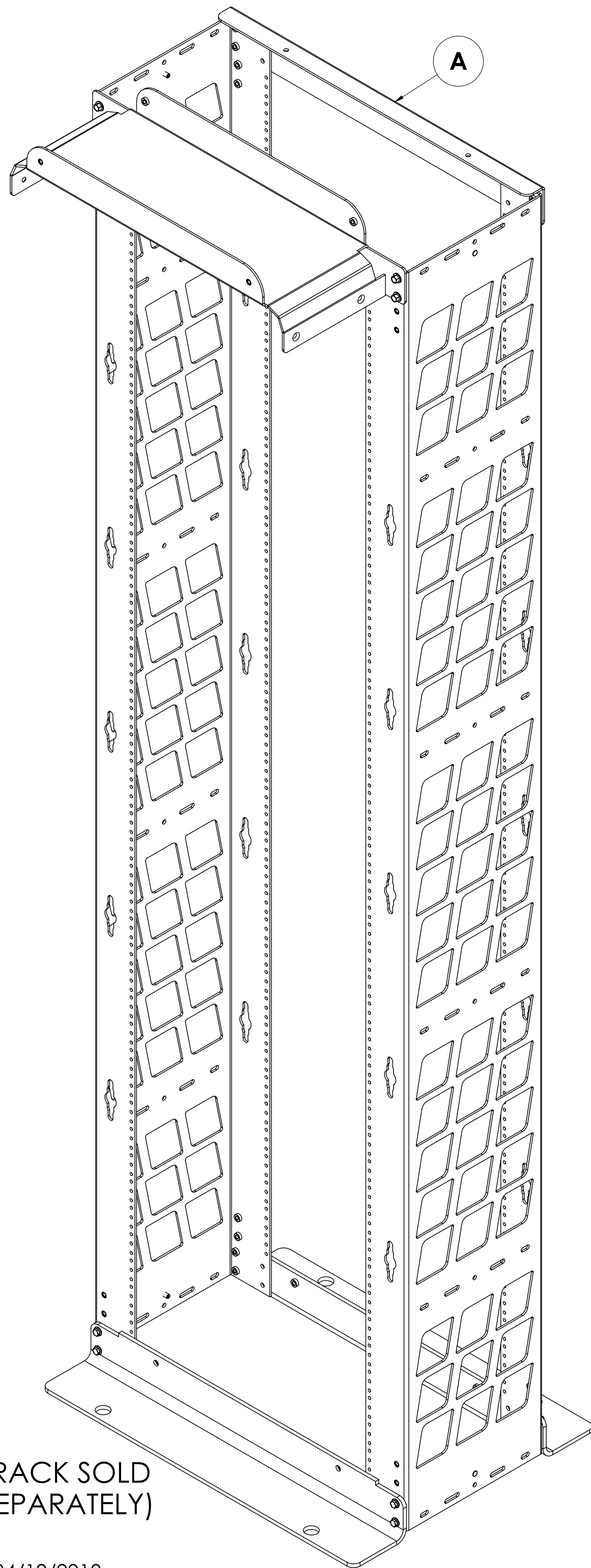
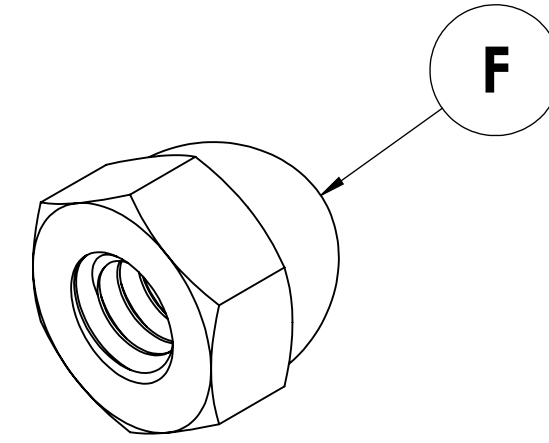

1/4-20
ACORN NUT
98667A210

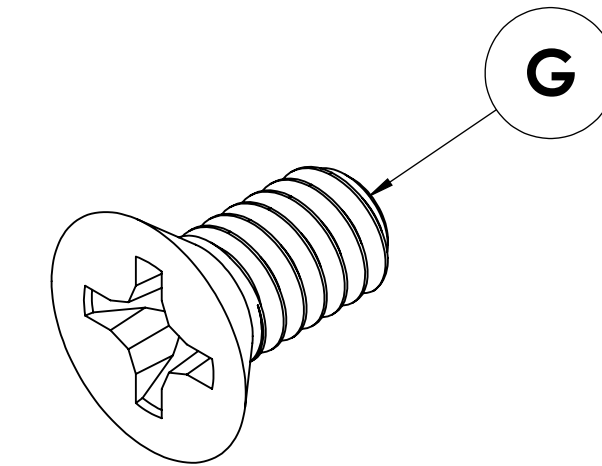

1/4-20 X 1/2L
FLAT HEAD SCREW
96640A150

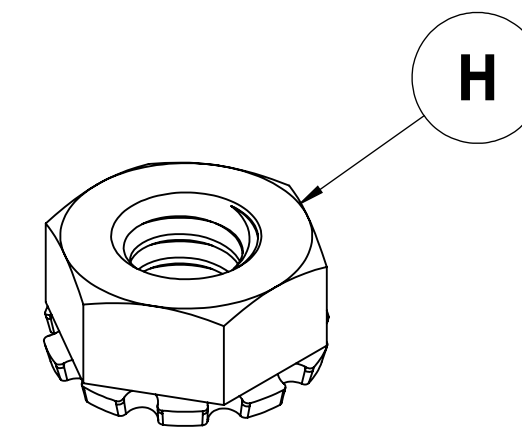

1/4-20
KEPS NUT
H17-25

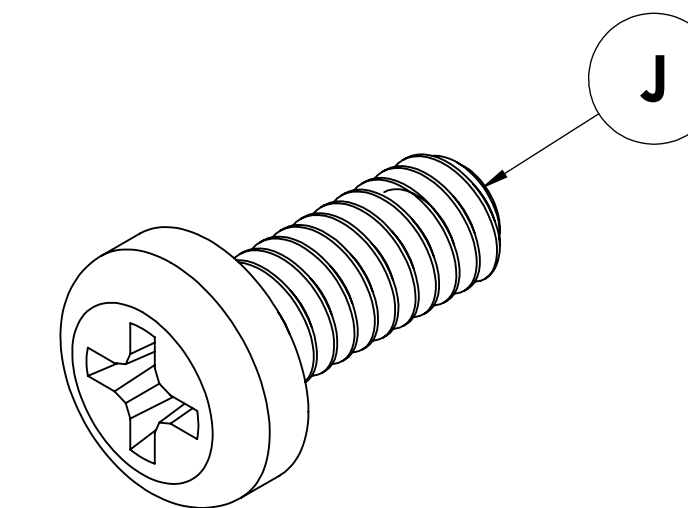

1/4-20 X 5/8L
NYLON
PAN HEAD SCREW
93135A453

(RACK SOLD
SEPARATELY)



1 INNOVATION DRIVE - DES PLAINES, IL 60016

L:\Engineering\IMS Product Project\TCM\Work_Instructions\TCMFDINST-2.0

STEP 1

Mount back panel to rack

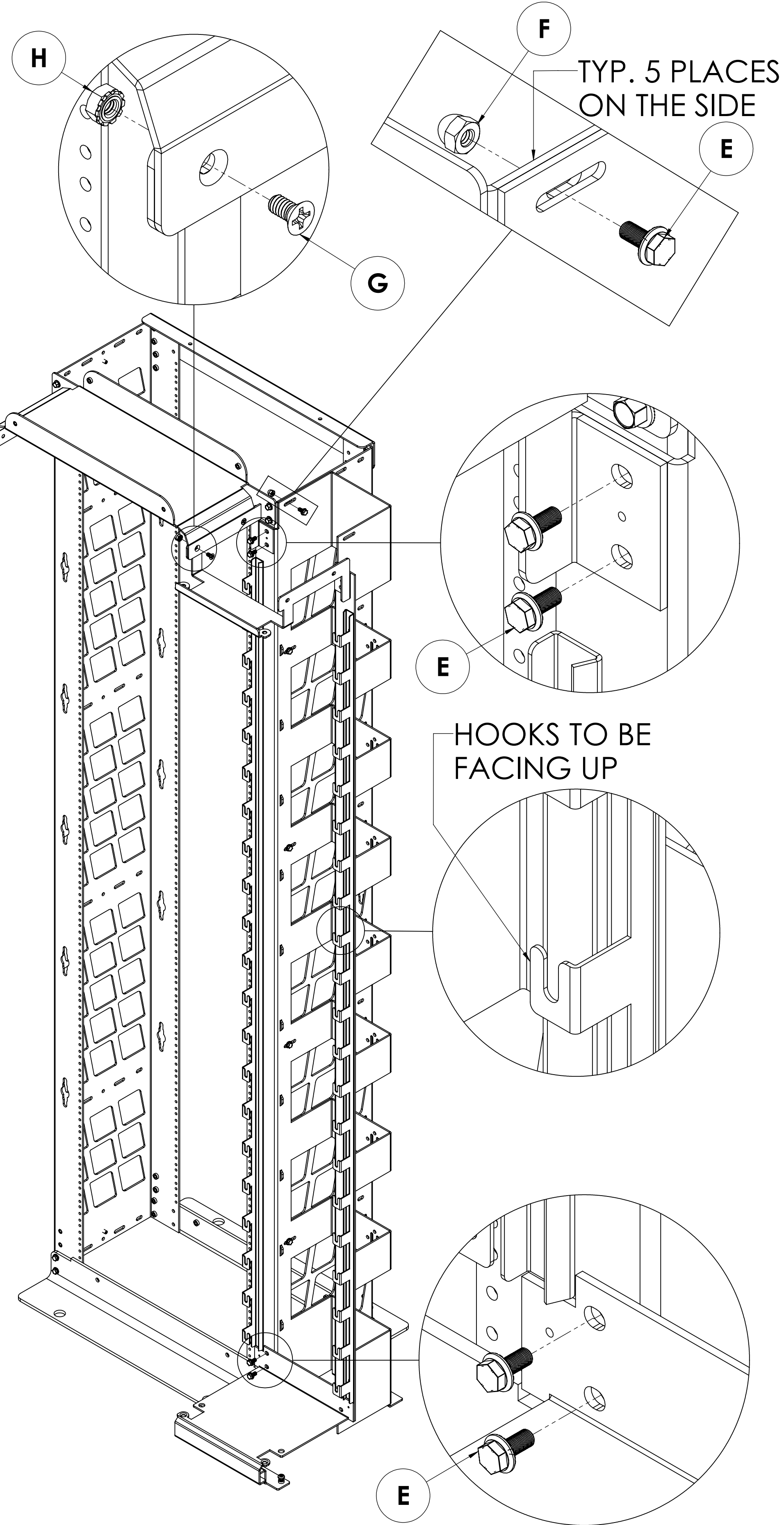

STEP 2

Mount fingers to back panel



STEP 3

Level cable manager and install door

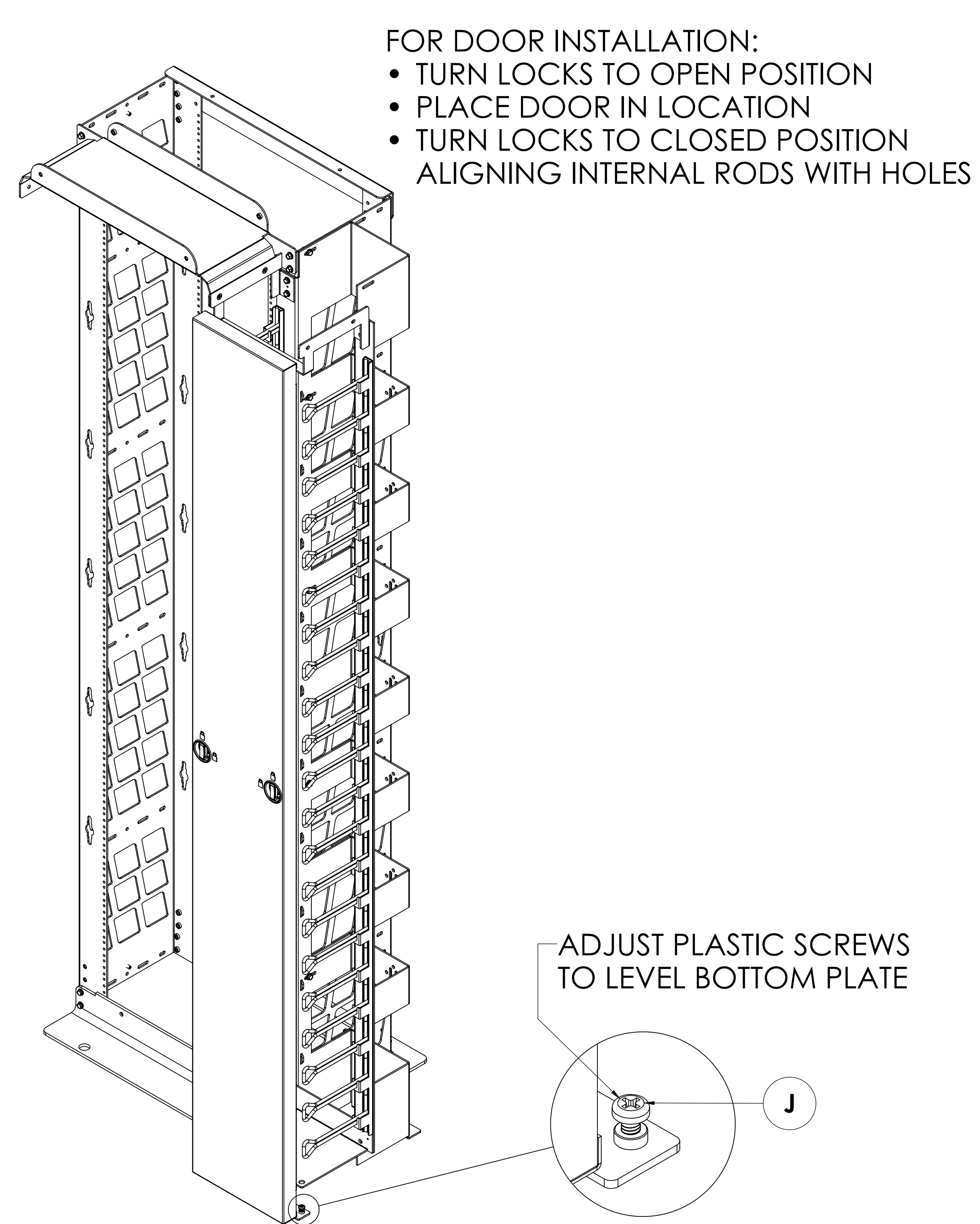

1 INNOVATION DRIVE - DES PLAINES, IL 60016

L:\Engineering\IMS Product Project\TCM\Work_Instructions\TCMFDINST-2.0