

Assembly Instructions for Back Panel with Fingers

Model number

VCTF-51U-1-6	VCTF-51U-1-8	VCTF-51U-1-10	VCTF-51U-1-12
VCTF-47U-1-6	VCTF-47U-1-8	VCTF-47U-1-10	VCTF-47U-1-12
VCTF-44U-1-6	VCTF-44U-1-8	VCTF-44U-1-10	VCTF-44U-1-12
VCTF-42U-1-6	VCTF-42U-1-8	VCTF-42U-1-10	VCTF-42U-1-12
VCTF-24U-1-6	VCTF-24U-1-8	VCTF-24U-1-10	VCTF-24U-1-12

VCTF-51U-2-6	VCTF-51U-2-8	VCTF-51U-2-10	VCTF-51U-2-12
VCTF-47U-2-6	VCTF-47U-2-8	VCTF-47U-2-10	VCTF-47U-2-12
VCTF-44U-2-6	VCTF-44U-2-8	VCTF-44U-2-10	VCTF-44U-2-12
VCTF-42U-2-6	VCTF-42U-2-8	VCTF-42U-2-10	VCTF-42U-2-12
VCTF-24U-2-6	VCTF-24U-2-8	VCTF-24U-2-10	VCTF-24U-2-12

Hardware

Qty. (12), 1/4-20 x 1/2" Pan Head Phillips Screw

Qty. (6), 1/4-20 Unistrut Nut w/ Spring

Qty. (6), "Z" Shape bracket

Tools

Screwdriver (Phillips)

Fingers Assembly Instructions:

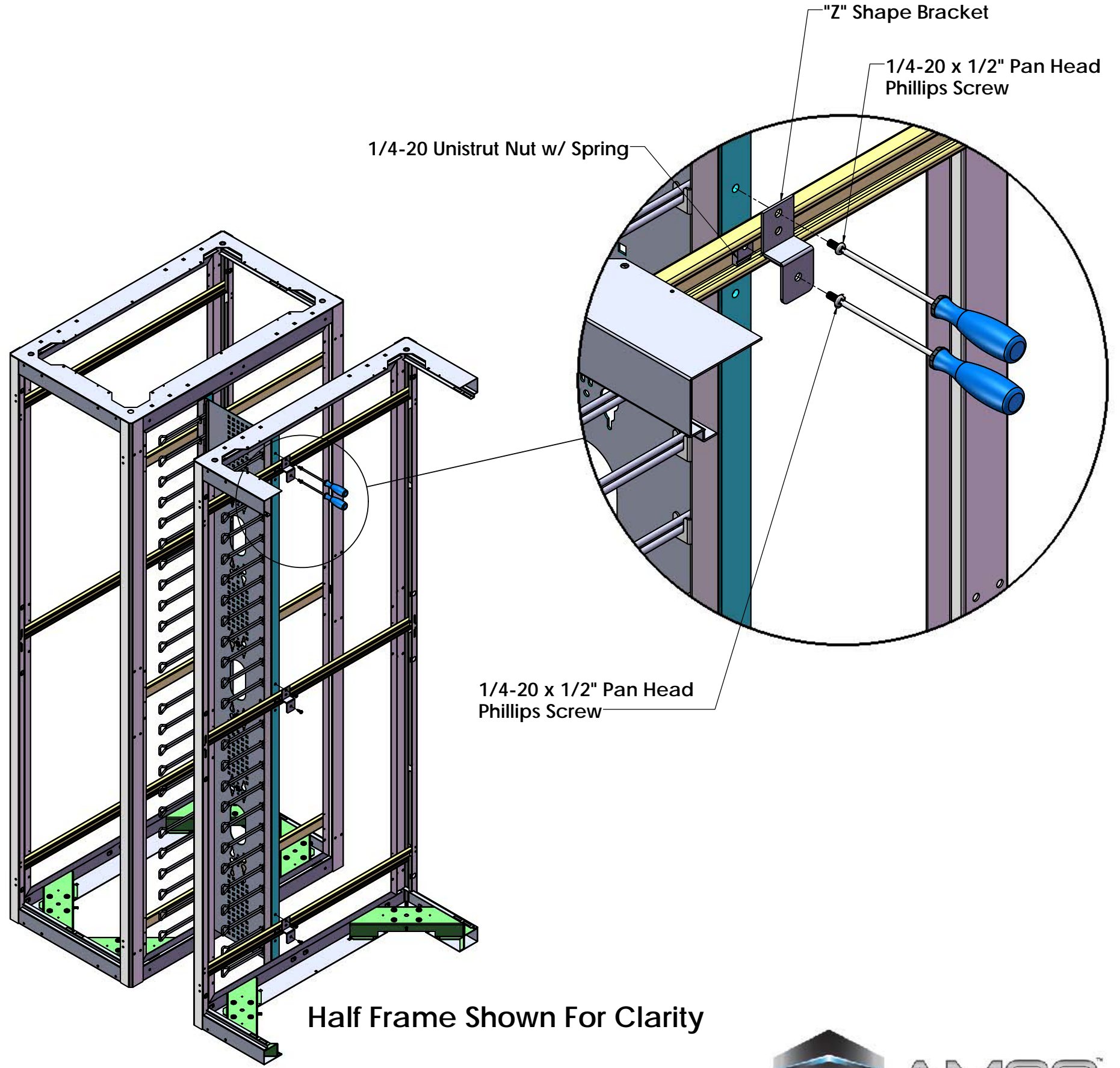
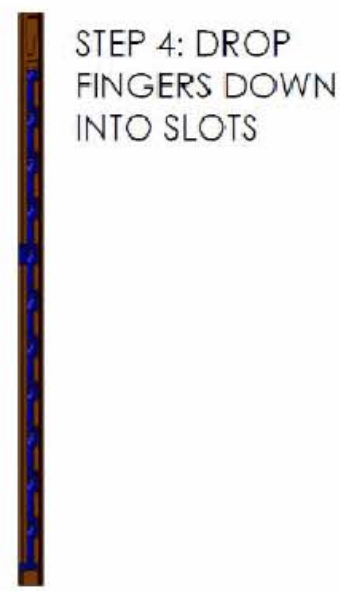
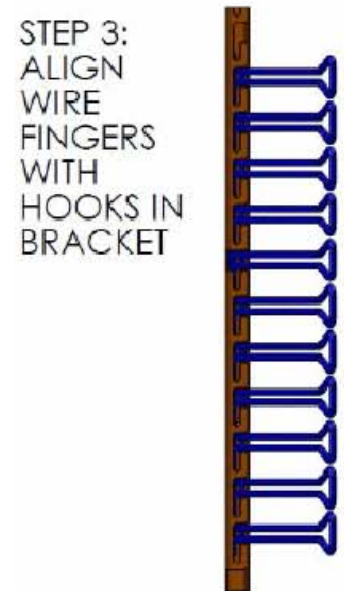
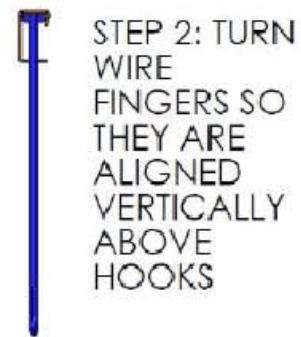
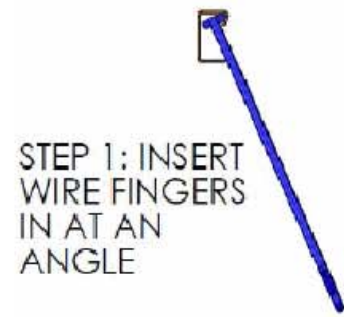

Half Frame Shown For Clarity



Assembly Instructions for Cable Raceway Door

Model number

VFTD-Z-51U-6	VFTD-Z-51U-8	VFTD-Z-51U-10	VFTD-Z-51U-12
VFTD-Z-47U-6	VFTD-Z-47U-8	VFTD-Z-47U-10	VFTD-Z-47U-12
VFTD-Z-44U-6	VFTD-Z-44U-8	VFTD-Z-44U-10	VFTD-Z-44U-12
VFTD-Z-42U-6	VFTD-Z-42U-8	VFTD-Z-42U-10	VFTD-Z-42U-12
VFTD-Z-24U-6	VFTD-Z-24U-8	VFTD-Z-24U-10	VFTD-Z-24U-12

VFTD-S-51U-6	VFTD-S-51U-8	VFTD-S-51U-10	VFTD-S-51U-12
VFTD-S-47U-6	VFTD-S-47U-8	VFTD-S-47U-10	VFTD-S-47U-12
VFTD-S-44U-6	VFTD-S-44U-8	VFTD-S-44U-10	VFTD-S-44U-12
VFTD-S-42U-6	VFTD-S-42U-8	VFTD-S-42U-10	VFTD-S-42U-12
VFTD-S-24U-6	VFTD-S-24U-8	VFTD-S-24U-10	VFTD-S-24U-12

Hardware

Qty. (8), 1/4-20 x 3/8" Pan Head Phillips Screw

Tools

Screwdriver (Phillips)

If frame's main rails have two holes, use the one on the inside (as shown)

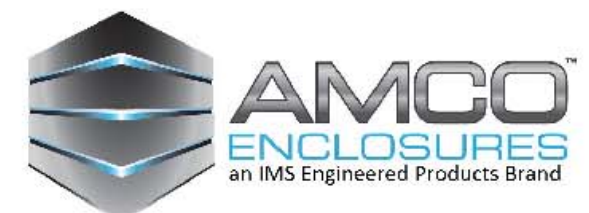
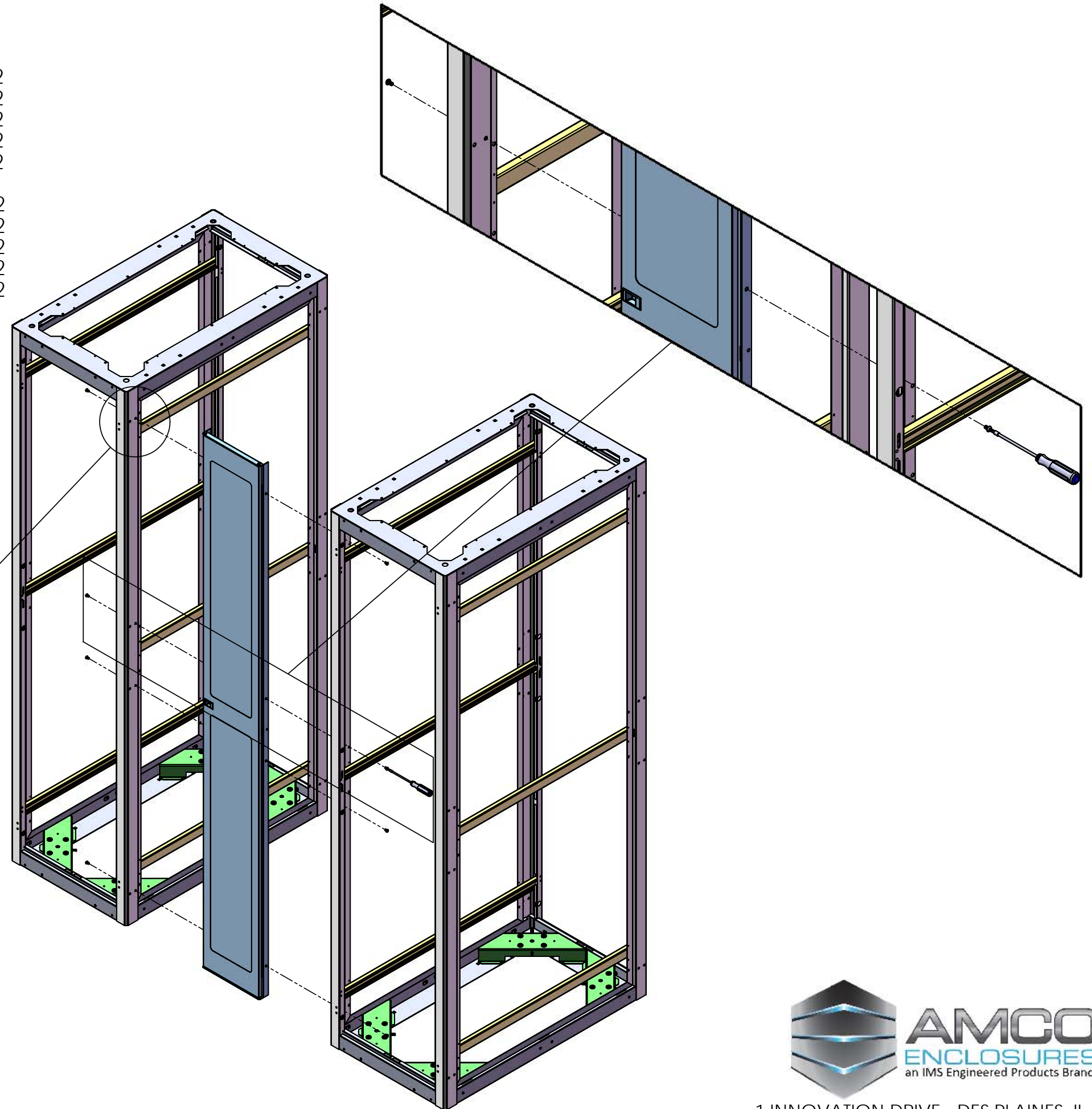
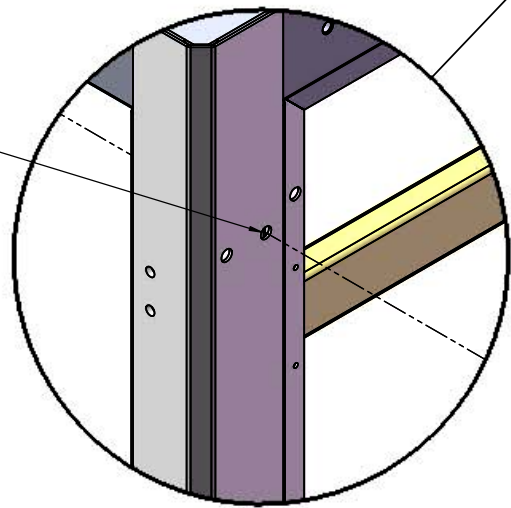

1 INNOVATION DRIVE - DES PLAINES, IL 60016